

CYFELCO LED ROUND HIGHBAY

CYFELCO 2 RHB 150W 840



PRODUCT DATA



952-075



General Information

Order Code	952-075
Product Description	CYFELCO 2 RHB 150W 840
Application	Industrial Spaces, Warehouses
Installation	Fixation with ceiling using suspension hook
Luminaire type	LED IP65 Highbay
Light Source	Round LED module
Number of light sources	1 pc
Light Source Colour	4000K, cool white
Driver	Built-in
Dimming	Not Dimmable
Energy Class	A+
Optical Risk	RG 0
Protection class	Class I
Ingress protection code	IP 65 [Dust penetration-protected, jet-proof]
Mechanical impact protection code	IK10
Standards	2014/30/EU Electromagnetic Compatibility Directive 2014/35/EU Low Voltage Directive 2011/65/EU Restriction of Hazardous Substances Directive (RoHS) 2009/125/EU Ecodesign Requirements for energy-related products
CE mark	Yes
Warranty	3 years

Electrical Data

Input Power	150 W
Input voltage	220-240V
Input Frequency	50-60 Hz
Power Factor	>0.95

Mechanical Characteristics

Housing Material	Die-cast aluminium
Optical Cover	Polycarbonate

Initial Performance

Initial Luminaire Luminous Flux	19500-21000 lm
Initial Luminaire Efficacy	130-140 lm/W
Initial Corr. Colour Temperature (CCT)	4000 K
Initial Color Rendering Index (CRI)	>80
UGR	<30

Logistics

Net weight per piece	3.5 kg
Gross weight per piece	4.5 kg
Volume	0.034 m ³
Packing	1 pc per carton

Over Time Performance

Driver Service Life Time	50,000 hrs
LED Median Useful Life L80B10	50,000 hrs

Application Conditions

Operating Temperature Range	-30 to +50 °C
-----------------------------	---------------

Dimensional Drawing

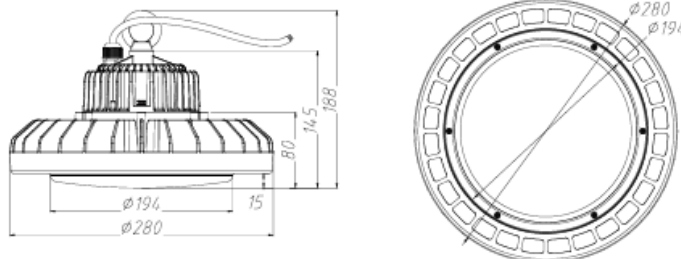

ELMASCO INDUSTRIES S.A.

Head Office : 44 K. Palama, 14343 N. Chalkidona, Athens, Greece

Production Plant : Ag. Adrianos, 21100 Nafplio, Greece

Email: elmasco@elmasco.eu

Tel : +30 210 2583100

Fax: +30 210 2583107

